

FARUKOLHUFUSHI DEVELOPMENT PLAN

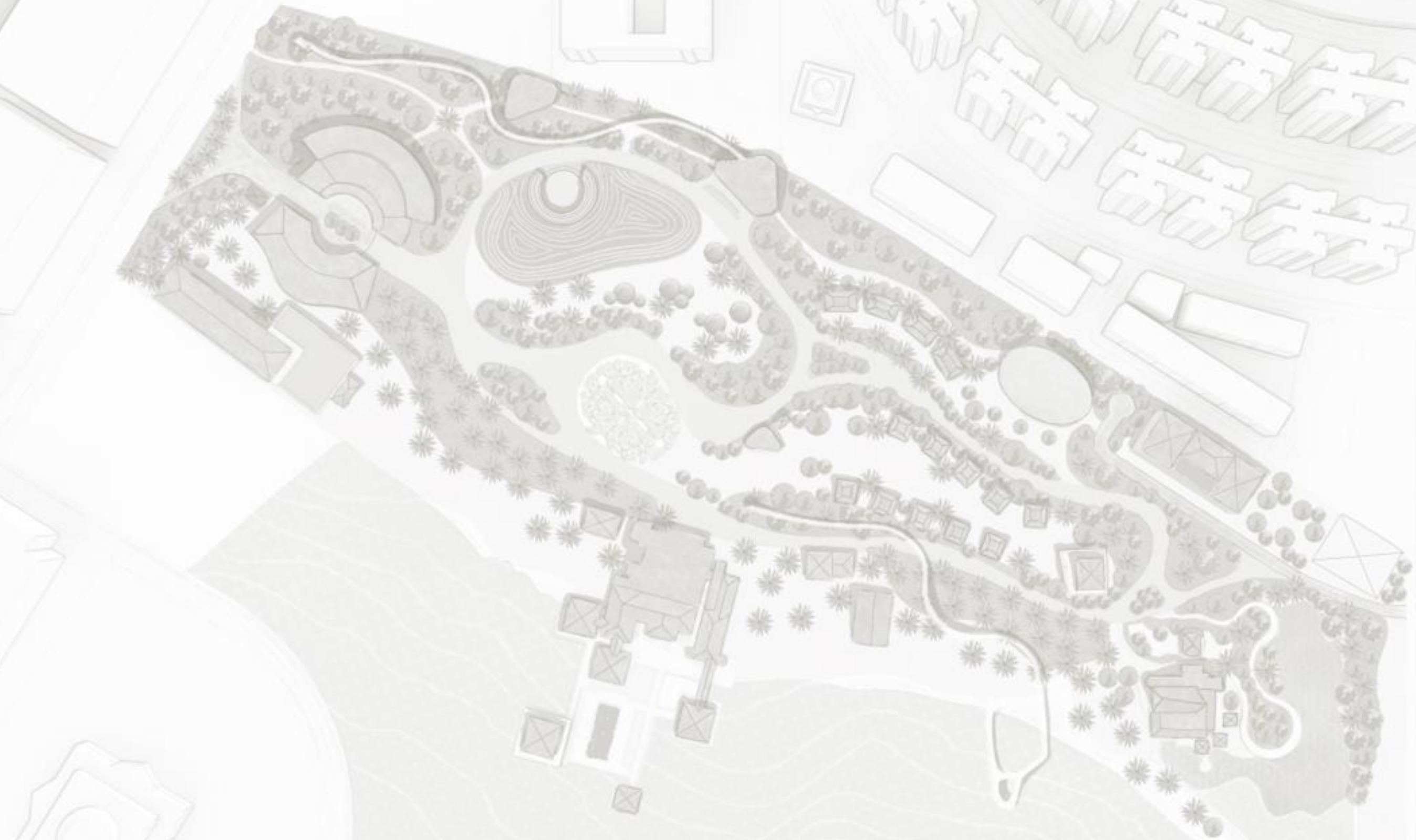

LANDSCAPE DESIGN SECTION
URBAN PLANNING DEPARTMENT



urbanco

PROPOSED MASTERPLAN CONCEPT



- 1 GUARDHOUSE
- 2 HERITAGE CENTER
- 3 ADMIN BUILDING
- 4 SERVICES BUILDING/NURSERY
- 5 COMMERCIAL KIOSK
- 6 KNOWLEDGE HUT
- 7 AMPHITHEATRE
- 8 MULTI-PURPOSE EVENTS GROUND
- 9 CAMPING GROUND
- 10 PUBLIC TOILET
- 11 EVENT SPACE
- 12 MAZE GARDEN
- 13 COMMERCIAL KIOSK
- 14 CULTURAL BOUTIQUES
- 15 ESJEHI GALLERY
- 16 ODIHARUGE
- 17 PUBLIC BEACH/MULTI-PURPOSE GROUND
- 18 SUNSET VIEWING DECK
- 19 LOCAL CUISINE RESTAURANT
- 20 FOLKLORE HUT
- 21 INTER-TIDAL BOARDWALK
- 22 HOTEL SCHOOL BUILDING
- 23 BALLROOM/EVENT HALL
- 24 CULTURAL VILLAS